

Comparative Rental Analysis



3/333 HIGH STREET MAITLAND NSW 2320

Prepared on 13th September 2024



Jade Tweedie
First National - David Haggarty





454 High St
MAITLAND NSW 2320

w: 4933 5544
jade@davidhaggarty.com.au

Comparable Rentals



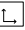

1 1/53 BANKS STREET EAST MAITLAND NSW 2323



 3  2  2  3,163m²  105m²
 Year Built 2005 DOM 24 days
 Listing Date 16-Jul-24 Distance 2.53km
 Listing Price \$550 per week



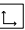

2 1/19A RAYMOND TERRACE ROAD EAST MAITLAND NSW 2323



 3  2  2  182m²  -
 Year Built - DOM 16 days
 Listing Date 25-Jul-24 Distance 4km
 Listing Price \$570 pw

3 3/10 CLARA STREET EAST MAITLAND NSW 2323



 3  2  2  252m²  129m²
 Year Built 2015 DOM 7 days
 Listing Date 09-Feb-24 Distance 3.42km
 Listing Price \$580 pw

Comps Map: Rentals

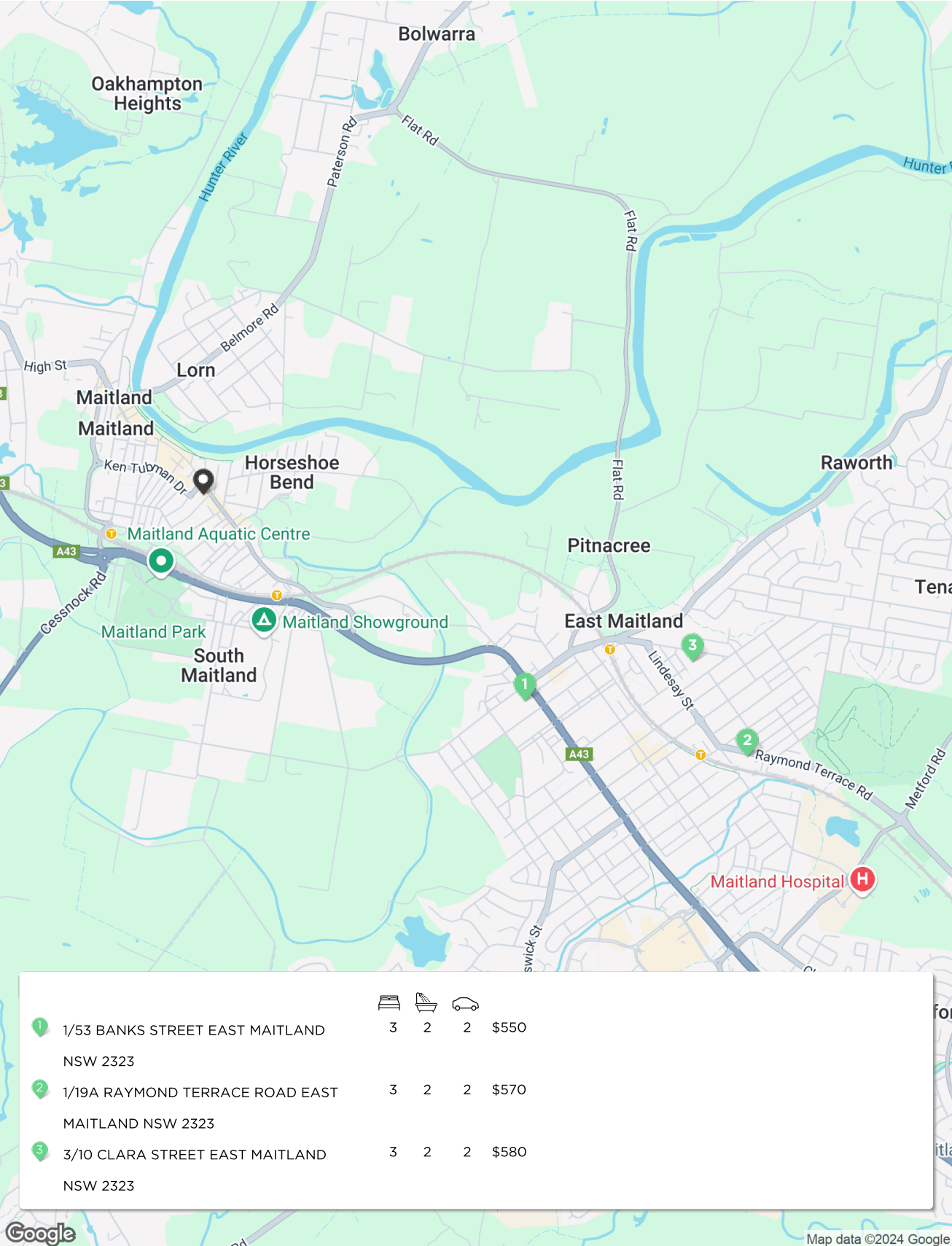

* This data point was edited by the author of this CMA and has not been verified by CoreLogic

Floor Plan

3-333 High Street, Maitland

Approximate Gross Internal Area = 111.7 sq m
Balcony = 24.1 sq m
(Excluding Void)

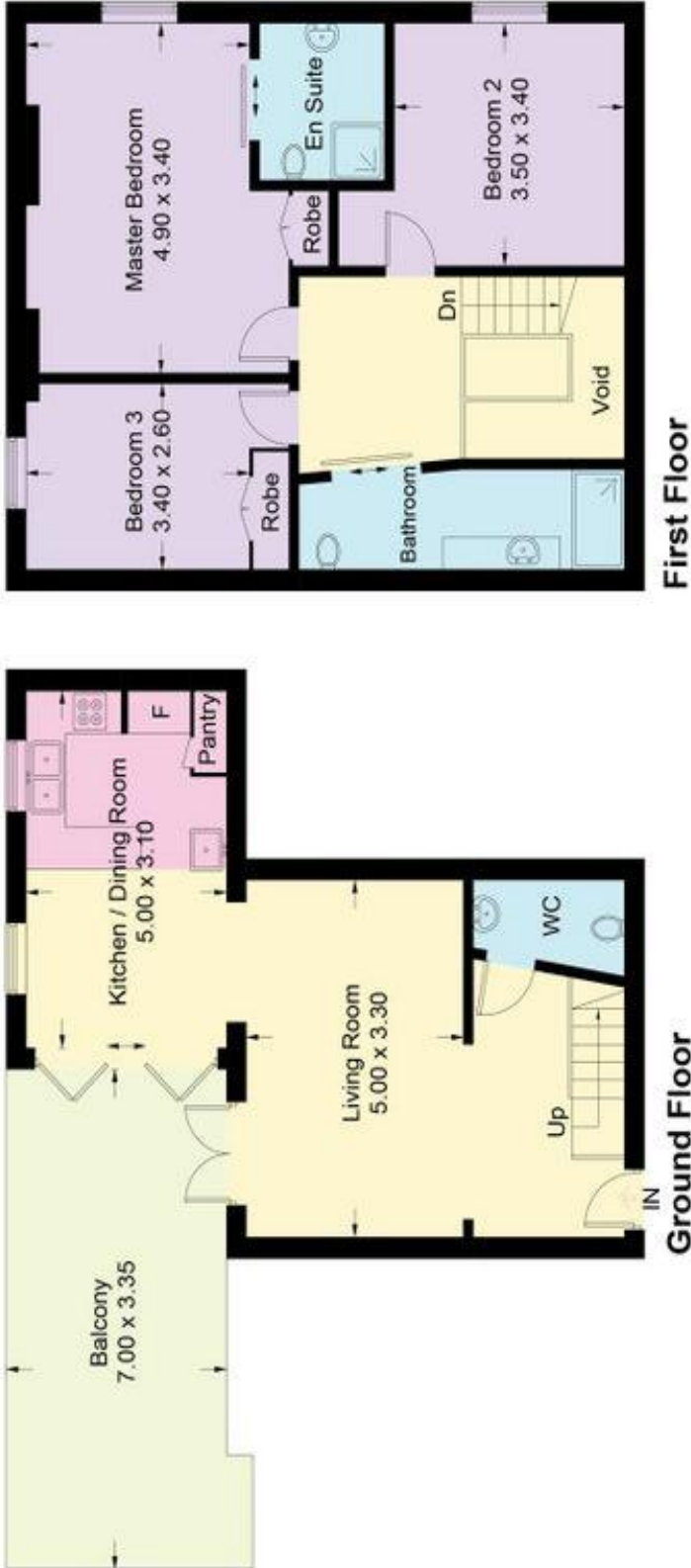
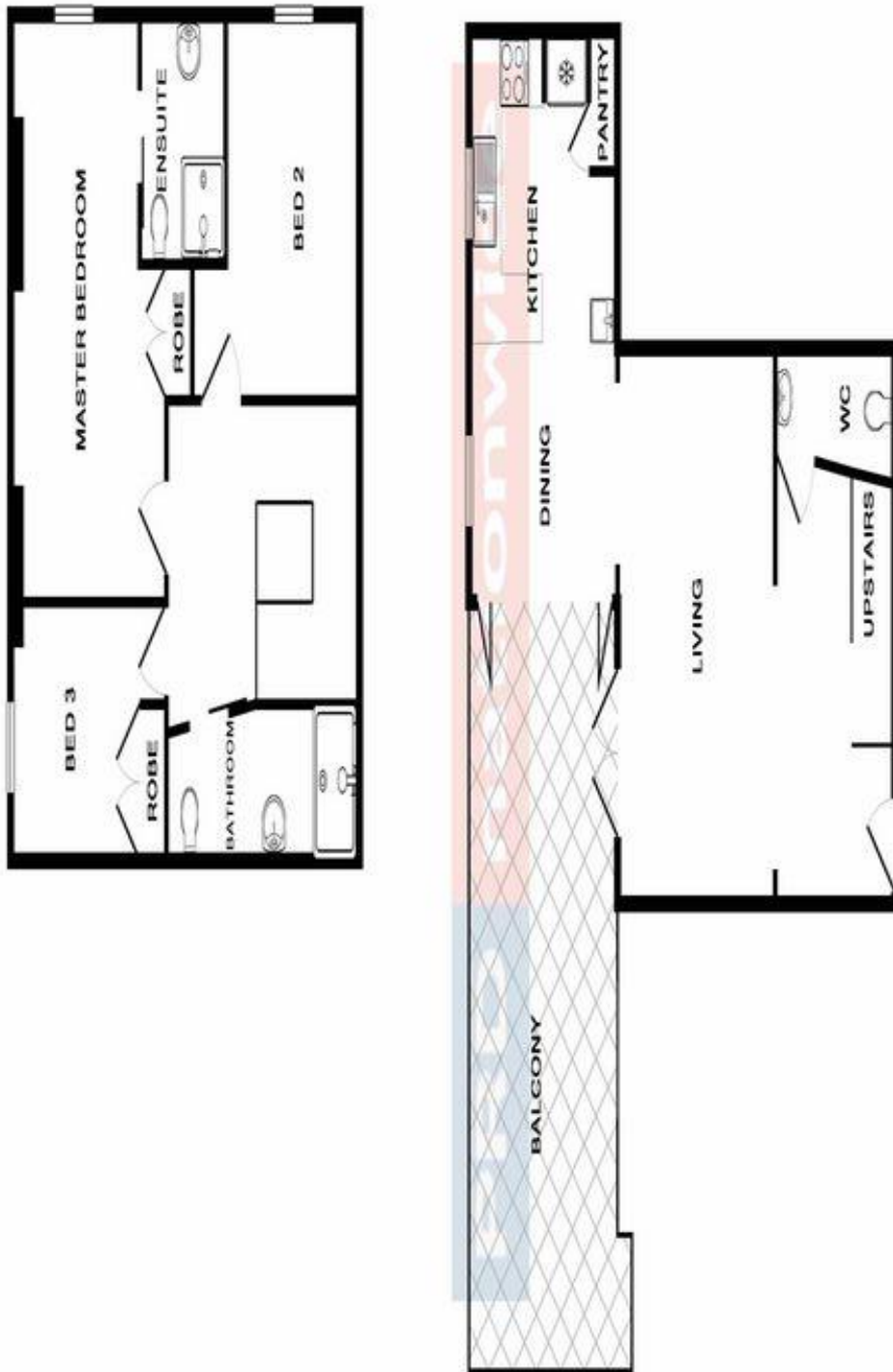

Illustration for identification purposes only, measurements are approximate, not to scale. floorplans.usketch.com © (ID679639)

Floor Plan



Whilst every attempt has been made to ensure the accuracy of this floor plan, we make no representation or warranty as to the accuracy of the floor plan. The floor plan is for information only and should not be relied upon for any purpose. The floor plan is subject to change without notice.

Current Market Review

3/333 HIGH STREET MAITLAND NSW 2320



Market Assessment

App. \$550

Notes from your agent

All pricing put forward is based on comparable pricing evidence and should be seen as a guide only.

Disclaimer

Contains property sales information provided under licence from the Land and Property Information (“LPI”). RP Data Pty Ltd trading as CoreLogic is authorised as a Property Sales Information provider by the LPI.

The Appraisal Amount contained in the report may have been manually provided by the Agent; or may be based on an automated valuation model estimate provided by CoreLogic ('AVM Estimated Value'). AVM Estimated Values are current at the date of the publication only. It is computer generated and is not a professional appraisal of the subject property and should not be relied upon in lieu of appropriate professional advice. The accuracy of the methodology used to develop the AVM Estimated Value, the existence of the subject property, and the accuracy of the AVM Estimated Value and all rule sets provided are estimates based on available data and are not guaranteed or warranted. CoreLogic excludes all liability for any loss or damage arising in connection with the Appraisal Amount and/or AVM Estimated Value.

A floor plan of a property is indicative only and may not be complete or accurate. Any floor plan that is produced is not intended or designed to replace the certificate of title or land survey.

Whilst all reasonable effort is made to ensure the information in this publication is current, CoreLogic does not warrant the accuracy or completeness of the data and information contained in this publication and to the full extent not prohibited by law excludes all for any loss or damage arising in connection with the data and information contained in this publication.